

EZ Clip system: GH001 Fittings

EJ3410

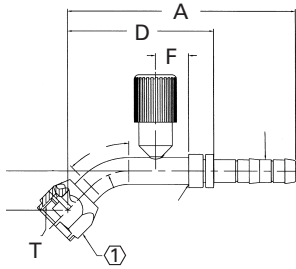

45° female O-Ring (short pilot) with R134a high side port

PART NUMBER	TH'D "T"	HOSE SIZE	A REF	D REF	F REF	H REF	① REF
FEJ3410-0808S	3/4-16	8	4.3	2.76	0.62	0.73	0.88

EJ3543

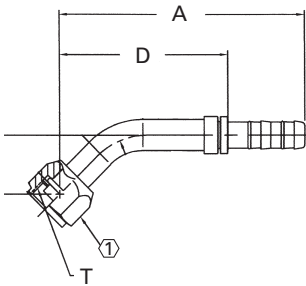

45° female O-Ring (short pilot) with R134a low side port (rotated 270°)

PART NUMBER	TH'D "T"	HOSE SIZE	A REF	D REF	F REF	H REF	① REF
EJ3543-1010S	7/8-14	10	4.99	3.44	0.52	1.19	1.06

FJ3012

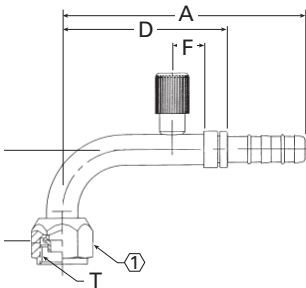

90° female O-Ring (short pilot) with R134a low side port

PART NUMBER	TH'D "T"	HOSE SIZE	A REF	D REF	F REF	H REF	① REF
FJ3012-02-1010S	7/8-14	10	4.88	3.33	0.63	1.89	1.06
FJ3012-01-1012S	7/8-14	12	4.83	3.25	0.63	1.89	1.06
FJ3012-03-1212S	1-1/16-14	12	5.1	3.52	0.63	2.56	1.25
FJ3012-04-1216S	1-1/16-14	16	5.2	3.52	0.63	2.56	1.25
FJ3012-05-1016S	7/8-14	16	5.2	3.52	0.63	1.89	1.06

FJ3013/EJ3302

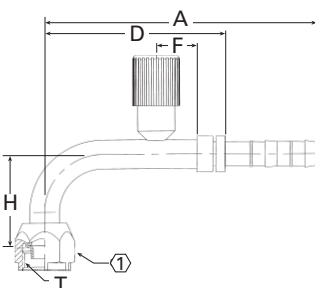

90° female O-Ring (short pilot) with R134a high side port

PART NUMBER	TH'D "T"	HOSE SIZE	A REF	D REF	F REF	H REF	① REF
FJ3013-02-0606S	5/8-18	6	4.35	2.82	0.63	1.38	0.75
FJ3013-03-0808S	3/4-16	8	4.61	3.07	0.69	1.62	0.88
FJ3013-01-0810S	3/4-16	10	4.53	2.98	0.69	1.62	0.88
FJ3013-06-1010S	7/8-14	10	4.29	3.24	0.94	2.37	1.06
EJ3302-01-0608S	M18 x 1.5	8	4.36	2.82	0.94	1.38	0.88
EJ3302-02-0808S	M20 x 1.5	8	4.52	2.98	0.69	1.62	0.94