

**EJ3533**

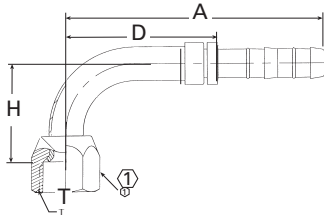

**90° female JIC 37° flare**

PART NUMBER	TH'D "T"	HOSE SIZE	A REF	D REF	F REF	H REF	① REF
EJ3533-02-0606S	9/16-18	6	3.27	1.74	—	1.69	0.69
EJ3533-03-0608S	9/16-18	8	3.28	1.74	—	1.69	0.69
EJ3533-04-0808S	3/4-16	8	3.14	1.60	—	1.77	0.88
EJ3533-05-1010S	7/8-14	10	3.78	2.23	—	2.59	1.00
EJ3533-06-1212S	1 1/16-12	12	4.11	2.53	—	3.02	1.25
EJ3533-07-1616S	1 5/16-12	16	5.16	3.48	—	3.86	1.50
EJ3533-01-0404S	7/16-20	4	2.09	1.42	—	1.21	0.56

**GA23911**

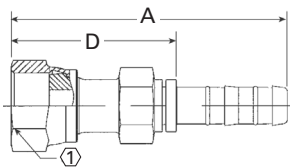

**Straight - ORS female swivel metric hex nut**

PART NUMBER	TH'D "T"	HOSE SIZE	A REF	D REF	F REF	H REF	① REF
GA23911-4-4*	9/16-18	4	1.86	1.19	-	-	17mm
GA23911-6-6*	1-1/16-16	6	2.95	1.43	-	-	22mm
GA23911-8-8*	1-3/16-16	8	3.17	1.62	-	-	24mm
GA23911-10-12*	1-14	12	3.32	1.74	-	-	30mm
GA23911-10-10*	1-14	10	3.33	1.78	-	-	30mm
GA23911-12-12*	1-3/16-12	12	3.32	1.52	-	-	41mm
GA23911-16-16*	1-5/16-12	16	3.30	1.52	-	-	41mm

\* GA Part numbers have a metric hex

**FJ3161/GA23912**

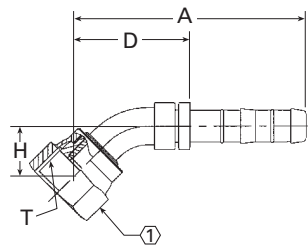

**45° ORS female swivel**

PART NUMBER	TH'D "T"	HOSE SIZE	A REF	D REF	F REF	H REF	① REF
FJ3161-05-0404S	9/16-18	4	1.86	1.01	—	0.41	0.69
FJ3161-01-0606S	11/16-16	6	2.65	1.12	—	0.44	0.81
FJ3161-02-0808S	13/16-16	8	3.02	1.47	—	0.59	0.94
FJ3161-03-1010S	1-14	10	3.22	1.67	—	0.70	1.13
FJ3161-04-1008S	1-14	8	3.32	1.78	—	0.70	1.13
GA23912-10-8*	1-14	8	3.50	1.96	—	0.68	30mm
GA23912-12-12*	1-3/16-12	12	4.23	2.65	—	0.83	36mm
F3161-08-0810S	13/16-16	10	3.02	1.47	—	0.59	0.940
GA23912-10-10*	1-14	10	3.77	2.22	—	0.68	30mm
GA23912-8-8*	13/16-16	8	3.43	1.89	—	0.59	30mm

\* GA Part numbers have a metric hex

**FJ5994/GA23913**

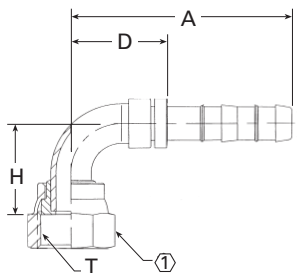

**90° ORS female swivel**

PART NUMBER	TH'D "T"	HOSE SIZE	A REF	D REF	F REF	H REF	① REF
FJ5994-01-0606S	1-1/16-16	6	2.50	0.98	—	0.91	0.81
FJ5994-02-0808S	13/16-16	8	2.74	1.20	—	1.15	0.94
FJ5994-04-1010S	1-14	10	3.09	1.53	—	1.27	1.12
FJ5994-03-1212S	1-3/16-12	12	3.36	1.78	—	1.90	1.38
FJ5994-05-0406S	9/16-18	6	2.44	0.92	—	0.82	0.69
FJ5994-05-1012S	1-14	12	3.11	1.53	—	1.78	1.13
FJ5994-07-0806S	13/16-16	6	2.66	1.10	—	1.15	0.94
FJ5994-09-1016S	1-14	16	3.30	1.62	—	1.78	1.125
GA23913-4-4*	9/16-18	4	2.04	1.37	—	0.82	17mm
GA23913-10-12*	1-14	12	3.67	2.10	—	1.54	30mm

\* GA Part numbers have a metric hex