

Reducing adapter with soft seal

RED ... -WD/...

RED ... -WD/...-1.4571

- With soft seal made from NBR** (e.g. Perbunan) for steel
- With soft seal made from FKM (e.g. Viton) for stainless steel (1.4571)
- Inch studs type E to DIN EN ISO 1179-2

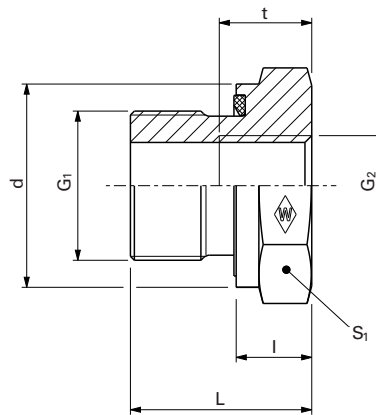

H

PN bar (psi)	DIN - ISO 228 (R..., DIN 259) G ₁	G ₂	Model	kg/ 100 pc.	L	l	d	t	S ₁	Art. no.	Stud RED ... -WD/...	Stud Stainless steel (1.4571) RED ... -WD/... VI-1.4571
											Art. no.	Art. no.
630 (9137)	G 3/8 A	G 1/8	RED-R 3/8-WD/R 1/8	4.0	22.5	10.5	21.9	8	22	WAL606600	WAL612428	
		G 1/8	RED-R 1/2-WD/R 1/8	6.6	24	10	26.9	8	27	WAL606601	WAL617813	
	G 1/2 A	G 1/4	RED-R 1/2-WD/R 1/4	6.0	24	10	26.9	12	27	WAL606602	WAL610622	
400 (5801)	G 3/4 A	G 1/4	RED-R 3/4-WD/R 1/4	9.5	26	10	31.9	12	32	WAL606603	WAL611180	
		G 3/8	RED-R 3/4-WD/R 3/8	9.0	26	10	31.9	12	32	WAL606604	WAL612089	
	G 1 A	G 1/4	RED-R 1 - WD/R 1/4	20.0	29	11	39.9	12	41	WAL606605	WAL615116	
		G 3/8	RED-R 1 - WD/R 3/8	18.0	29	11	39.9	12	41	WAL606606	WAL617814	
	G 1 1/4 A	G 1/2	RED-R 1 1/4-WD/R 1/2	16.0	29	11	39.9	14	41	WAL606607	WAL611254	
		G 3/4	RED-R 1 1/4-WD/R 3/4	31.0	32	12	49.9	14	50	WAL606608	WAL613813	
G 1 1/2 A	G 1/2	RED-R 1 1/2-WD/R 1/2	27.0	32	12	49.9	16	50	WAL606609	WAL612044		
	G 3/4	RED-R 1 1/2-WD/R 3/4	47.0	36	12	54.9	14	55	WAL606610	WAL613127		
	G 1	RED-R 1 1/2-WD/R 3/4	43.0	36	14	54.9	16	55	WAL606611	WAL615258		
		G 1	RED-R 1 1/2-WD/R 1	34.5	36	14	54.9	18	55	WAL606612	WAL612103	

△ Caution: The pressure specifications refer to the steel version. For the stainless steel version (1.4571), please refer to the pressure specifications on page B5.

**FPM (e.g. Viton) see price list / available on request