

Socket Weld 4-Bolt

Deep socket pipe guide reduces skilled welding labor
Standard & Companion ~ Pipe & Tube* models



DMIC's **FWI** Deep Socket Weld flanges contain a deep pipe guide that ensures square and true welded connections. Extensive stock of all sizes for rapid shipment.

- Sizes from 1/2" through 4"
- Extensive stock of "Standard" and "Companion" types
- Available in Stainless Steel (production leadtime may apply)
- DMIC "Standard" flanges designed to accept either UNC or metric bolts

Standard Socket Weld Flanges (with O-Ring Groove)

Standard Flange Part Number	Size		Working PSI	Dimensions (inches)										O-Ring
	Flange	Pipe OD		A	B	C	D	E	F	G	H	K	lbs.	
FWISL (Socket Weld, Standard, C.61)														
FWISL-0500SN	1/2"	0.84	5000	0.51	2.24	1.81	1.50	0.69	1.42	0.63	0.35	0.75	0.55	2-210
FWISL-0750SN	3/4"	1.05	5000	0.75	2.56	1.97	1.88	0.88	1.42	0.71	0.43	0.75	0.82	2-214
FWISL-1000SN	1"	1.31	5000	0.98	2.76	2.17	2.06	1.03	1.50	0.71	0.43	0.75	0.99	2-219
FWISL-1250SN	1 1/4"	1.66	4000	1.26	3.11	2.68	2.31	1.19	1.61	0.83	0.45	0.87	1.46	2-222
FWISL-1500SN	1 1/2"	1.91	3000	1.50	3.66	3.07	2.75	1.41	1.77	0.98	0.53	0.94	2.27	2-225
FWISL-2000SN	2"	2.38	3000	2.01	4.02	3.54	3.06	1.69	1.77	0.98	0.53	1.02	2.58	2-228
FWISL-2500SN	2 1/2"	2.88	2500	2.48	4.49	4.13	3.50	2.00	1.97	0.98	0.53	1.18	3.37	2-232
FWISL-3000SN	3"	3.50	2000	2.87	5.28	4.88	4.19	2.44	1.97	1.06	0.69	1.34	4.61	2-237
FWISL-3500SN	3 1/2"	4.00	500	3.50	5.98	5.35	4.75	2.75	1.89	1.06	0.69	1.34	5.18	2-241
FWISL-4000SN	4"	4.50	500	3.90	6.38	5.75	5.13	3.06	1.89	1.06	0.69	1.34	5.95	2-245
FWISH (Socket Weld, Standard, C.62)														
FWISH-0500SN	1/2"	0.84	6000	0.51	2.24	1.81	1.59	0.72	1.42	0.63	0.35	0.75	0.55	2-210
FWISH-0750SN	3/4"	1.05		0.75	2.80	2.17	2.00	0.94	1.38	0.83	0.43	0.87	1.12	2-214
FWISH-1000SN	1"	1.31		0.98	3.19	2.56	2.25	1.09	1.65	0.98	0.51	0.87	1.76	2-219
FWISH-1250SN	1 1/4"	1.66		1.26	3.74	3.07	2.63	1.25	1.77	1.06	0.59	0.98	2.49	2-222
FWISH-1500SN	1 1/2"	1.91		1.50	4.41	3.70	3.13	1.43	1.97	1.18	0.67	1.10	4.10	2-225
FWISH-2000SN	2"	2.38		2.01	5.28	4.49	3.81	1.75	2.56	1.46	0.83	0.94	7.28	2-228
FWISH-2500SN	2 1/2"	3.02		2.48	7.09	5.98	4.87	2.31	3.15	1.77	1.02	1.18	15.40	2-232
FWISH-3000SN	3"	3.56		2.87	8.19	7.01	6.00	2.81	3.54	2.17	1.30	1.18	24.64	2-237



Ordering Codes Summary

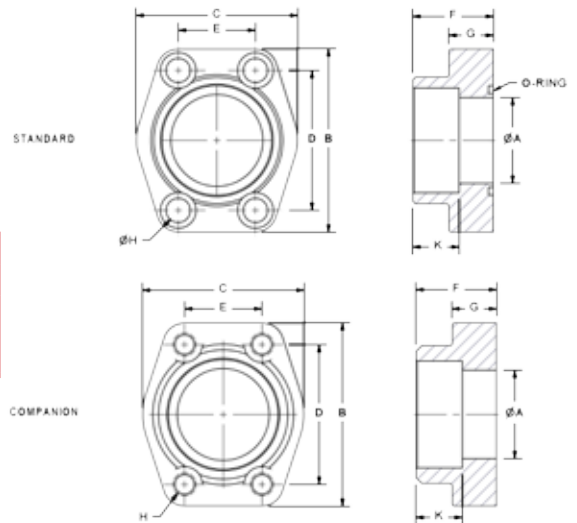
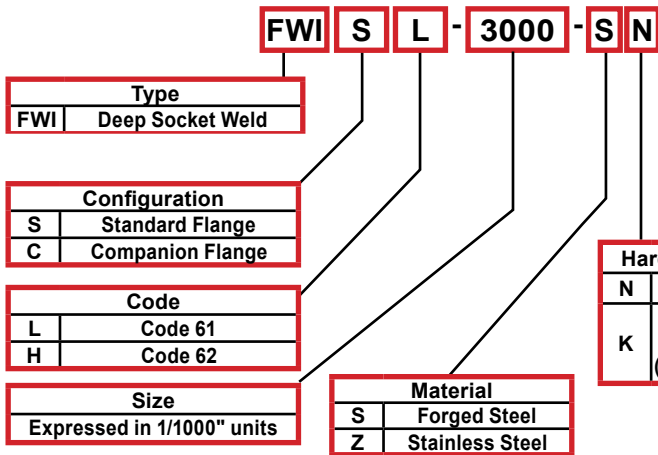

Due to our policy of continual product improvement, the specifications in this catalog may change without notice. When designing by spec, please request a certified print.

Companion Socket Weld Flanges (with Tapped Bolt Holes)

Companion Flange Part Number	Size		Working PSI	Dimensions (inches)									
	Flange	Pipe OD		A	B	C	D	E	F	G	H (UNC)	K	lbs.
FWICL (Socket Weld, Companion, C.61)													
FWICL-0500SN	1/2"	0.84	5000	0.51	2.24	1.81	1.50	0.69	1.42	0.63	5/16"	0.75	0.55
FWICL-0750SN	3/4"	1.05	5000	0.75	2.56	1.97	1.88	0.88	1.42	0.71	3/8"	0.75	0.86
FWICL-1000SN	1"	1.31	5000	0.98	2.76	2.17	2.06	1.03	1.50	0.71	3/8"	0.75	1.01
FWICL-1250SN	1 1/4"	1.66	4000	1.26	3.11	2.68	2.31	1.19	1.61	0.83	7/16"	0.87	1.57
FWICL-1500SN	1 1/2"	1.91	3000	1.50	3.66	3.07	2.75	1.41	1.77	0.98	1/2"	0.94	2.45
FWICL-2000SN	2"	2.38	3000	2.01	4.02	3.54	3.06	1.69	1.77	0.98	1/2"	1.02	2.62
FWICL-2500SN	2 1/2"	2.88	2500	2.48	4.49	4.13	3.50	2.00	1.97	0.98	1/2"	1.18	3.09
FWICL-3000SN	3"	3.50	2000	2.87	5.28	4.88	4.19	2.44	1.97	1.06	5/8"	1.34	4.74
FWICL-3500SN	3 1/2"	4.00	500	3.50	5.98	5.35	4.75	2.75	1.89	1.06	5/8"	1.34	5.29
FWICL-4000SN	4"	4.50	500	3.90	6.38	5.75	5.13	3.06	1.89	1.06	5/8"	1.34	6.28
FWICH (Socket Weld, Companion, C.62)													
FWICH-0500SN	1/2"	0.84	6000 PSI	0.51	2.24	1.81	1.59	0.72	1.42	0.63	5/16"	0.75	0.57
FWICH-0750SN	3/4"	1.05		0.75	2.80	2.17	2.00	0.94	1.38	0.83	3/8"	0.87	1.10
FWICH-1000SN	1"	1.31		0.98	3.19	2.56	2.25	1.09	1.65	0.98	7/16"	0.87	1.68
FWICH-1250SN	1 1/4"	1.66		1.26	3.74	3.07	2.63	1.25	1.77	1.06	1/2"	0.98	2.65
FWICH-1500SN	1 1/2"	1.91		1.50	4.41	3.70	3.13	1.44	1.97	1.18	5/8"	1.10	4.28
FWICH-2000SN	2"	2.38		2.01	5.28	4.49	3.81	1.75	2.56	1.46	3/4"	0.94	7.54
FWICH-2500SN	2 1/2"	3.02		2.48	7.09	5.98	4.87	2.31	3.15	1.77	7/8"	1.18	15.95
FWICH-3000SN	3	3.56		2.87	8.19	7.01	6.00	2.81	3.54	2.17	1 1/8"	1.18	25.96

Installation Tips for Socket Weld Flanges - Pipe & Tube

1. PREPARE PIPE BEFORE WELDING

For best results, remove all burrs and cutting residue before welding. Debris can compromise the quality of the weld and contaminate the system.

2. TACK WELD FLANGE INTO POSITION

Determine the correct orientation of flange ports before commencing.

Align flange to specifications and tack weld into place. Remove accumulated welding scale.

3. PROCEED TO WELD FLANGE TO PIPE

Minimize weld splatter. Remove all weld scale before joining weld pass and between multiple passes. Ensure that all tapped holes and SHCS eye holes are clear of scale before use.

